

## REPLACEMENT PARTS LIST - MODEL FT-6035

Part Number	Description	Part Number	Description
6021	View Window	2004	Lid Gasket (SPECIFY MODEL)
2010	Glove Clamp	2011	Glove Insert
2018	*Gauge	2015	Pickup Hose & Tube (SPECIFY MODEL)
2023	24" Unlined Gloves (Pair)	2013	3/8" ID Air Hose (SPECIFY MODEL)
4056	Window/Door Gasket (SPECIFY MODEL)	4056	Lid Gasket (SPECIFY MODEL)
2057	*12 Pack Mylar Shields	2027	Window Frame (SPECIFY MODEL)
2019	*Regulator	2032	Safety Valve
2031	Foot Pedal Assembly	2074	32" Lined Gloves (Pair)
7010	*Nozzle Holder (Foot Pedal Gun)	2028	Door Handle (QUANTITY VARIES BY MODEL)
7008	25 CFM Tungsten Carbide Nozzle	7000	25 CFM Complete Assembly
7001	O-Ring & Washer Set	7004	25 CFM Steel Orifice

Items marked (\*) are accessories and \*DO NOT\* come standard with this unit. They can be purchased separately. See DC-1500 / DC-4000 (if so equipped) manual for dust collector system parts.

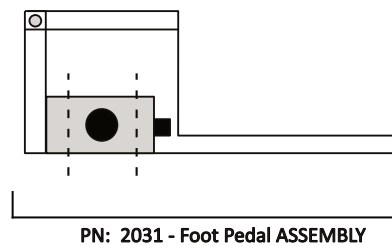
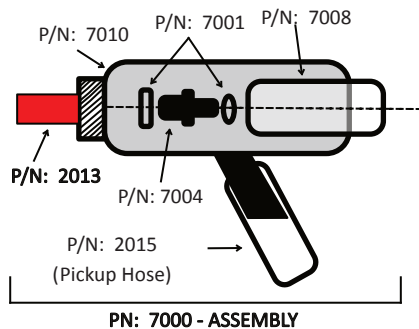
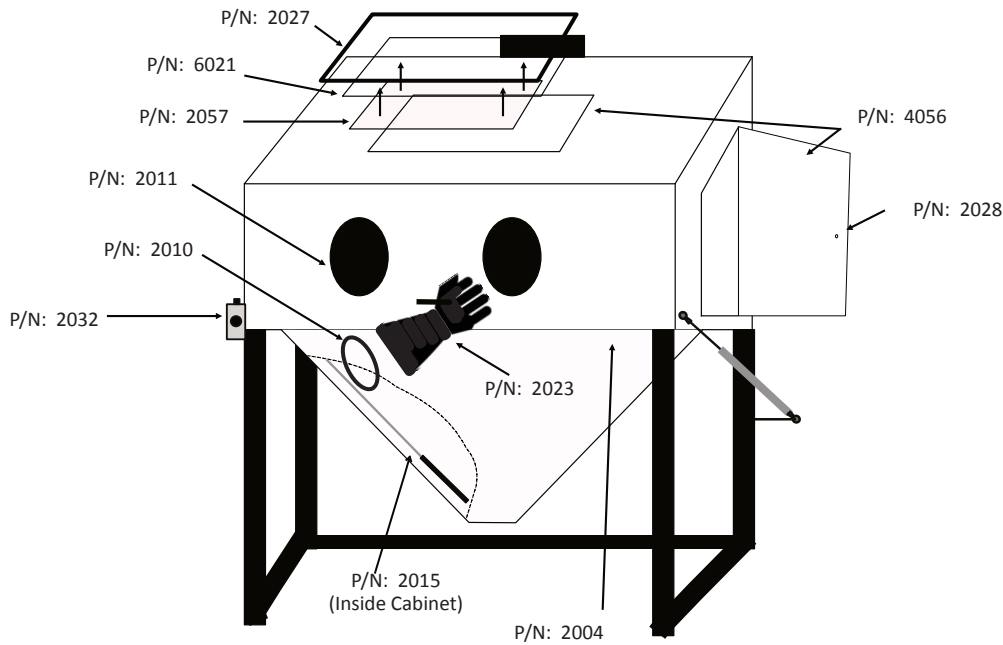

PO Box 815  
Dowagiac, MI 49047  
269-782-9670 (phone)  
269-782-9623 (fax)

info@cycloneblasters.com \* cycloneblasters.com

### ATTENTION

MODEL FT-6035 & 5532 PARTS & INSTRUCTION MANUAL

Cyclone blast cabinets produce a powerful flow of abrasive particles. To avoid personal injury and property damage, read this manual thoroughly before operating. Keep manual handy for future reference and replacement parts list. **Safety alert signal words based on ANSI Z535.4-1998 are used to alert the user of a potentially hazardous situation that may be encountered during operation of this equipment. ANSI definitions are as follows.**

### CAUTION

{ Caution used without the alert symbol indicates a potentially hazardous situation which, if not avoided, may result in property damage.



### CAUTION

{ Caution indicates a potentially hazardous situation which, if not avoided, may result in minor or moderate damage.



### WARNING

{ Warning indicates a potentially hazardous situation which, if not avoided, could result in serious injury or death.



### DANGER

{ Danger indicates an imminently hazardous situation which, if not avoided, will result in serious injury or death.

### CAUTION

1. Follow all electrical and safety codes as well as the National Electric Code (NEC) and the Occupational Safety & Health Act (OSHA).
2. Follow assembly instructions BEFORE plugging system into electrical or air supply. Always unplug blaster before changing light bulb to avoid electrical shock or damage to the lamp holder.



### CAUTION

1. The unit is equipped with a 3 prong grounding plug for your protection against electrical shock. Use only adequate extension cords with 3 prong grounding type plugs which are appropriate for long periods of use. Replace damaged or worn extension cord(s) immediately. Use a 3 prong receptacle to plug system or extension cord into.
2. Make sure power source conforms to the requirements of your equipment.
3. This is a dry blast system. It is not made to accommodate use with anything liquid or metal.
4. Change blasting material regularly. Continued use of abrasives will result in poor performance and excess dust.
5. DO NOT exceed recommended maximum air pressure of 120 PSI.
6. Check and clean dust collection system and filters regularly. Do not wait until dust is escaping from dust collection housings and/or blast cabinet before cleaning the system.



### WARNING

1. Keep any spilt blast abrasive clear from all paths around and near the blast cabinet. Many blast abrasives are powder fine and can be very slippery, causing a person to slip and fall.
2. Silica sand should be avoided for use in blast systems for health reasons.



### DANGER

1. DO NOT OPERATE CABINET WITH LID AND/OR DOOR OPEN! THIS WILL RESULT IN SKIN DAMAGE, SERIOUS EYE DAMAGE OR BLINDNESS AND OTHER HEALTH RISKS IF THE BLAST STREAM WERE TO COME INTO CONTACT WITH PARTS OF THE BODY.
2. This system is assembled with a standard 1/4" thick clear acrylic view window. Replacement with tempered or single strength glass is DANGEROUS. Replacing view window with material other than acrylic will result in dangerous glass breakage that can injure the operator or bystanders.
3. NEVER USE ANY TYPE OF FLAMMABLE OR COMBUSTABLE MATERIAL IN THIS BLAST SYSTEM.

## INSTALLATION

- Unwrap plastic from cabinet. Lift lid, remove dust collector (if supplied), unwrap foot pedal (if so equipped).
- Cabinet is fully assembled, once you place cabinet on the floor under your work table (if equipped with foot pedal).
- Electrical system is already installed. Light bulbs are not included. 70 watt max bulbs is/are required but not included. Screw in fluorescent, LED, or rough service bulbs.
- Attaching air to the cabinet differs for trigger and pedal operated systems. TRIGGER OPERATED: Attach air fittings & hose FROM YOUR COMPRESSOR to the 1/4" NPT port located on the outside left of the cabinet. FOOT PEDAL OPERATED: Attach air fitting & hose FROM YOUR COMPRESSOR to the 1/4" NPT port side of the foot pedal. There is already a hose attached to the foot pedal. Attach the other end to the fitting on the outside left of the cabinet.
- A thread sealant is suggested. DO NOT over tighten hose into valve. 60-90 PSI required.

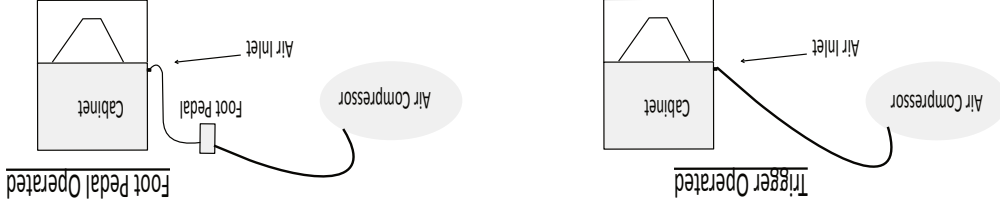

## DUST COLLECTION SYSTEM

Assemble the dust collector system according to the manufacturers directions. The dust collector hose will slide right into the 2.25" hole on the upper left side of the cabinet. It will fit snugly so there should be no need for any holding device(s). The cabinet has a 3-pronged grounded receptacle to guard against electrical shock. If only 2 pronged receptacle is available, a ground adapter can be used. Make sure the green lead is properly attached to a grounded wire system. If any extension cords are used, be sure they are in good condition. NOTE: THE CANADIAN ELECTRICAL CODE PROHIBITS THE USE OF 3-PRONGED ADAPTERS.

## BASIC OPERATION

- Pour dry blast through the metal screen on the inside of the cabinet into the cabinet hopper. We suggest no more than 10-15 pounds. Use of anything liquid or metal is NOT suggested. This system is not equipped for use with soda blast material.
- Place part to be blasted on work grate inside cabinet.
- Close door(s)/lids/top/latches. If equipped, make sure the door(s) is (are) also closed and securely latched as well.
- Turn cabinet light switch ON. Cabinet switch also controls cabinet receptacle where dust collector is plugged in.
- Place hands into gloves, hold onto the blast gun assembly.
- Operate Blast System
- Foot pedal operated systems: Depress foot pedal and keep your spray pattern moving across your part.
- Trigger operated systems: Pull trigger and keep your spray pattern moving across your part.

## WARNING

DO NOT POINT BLAST PENCIL/GUN SYSTEM AT THE VIEW WINDOW! This will cause the window to irreparably frost and be damaged - RESULTING IN PERSONAL INJURY.

## LIMITED WARRANTY

Cyclone abrasive blast cabinets are warranted against defects in workmanship or materials in accord with the following terms:

- Warranty extends to original owner only.
- Warranty does not cover blast cabinets used in commercial rentals
- Warranty is valid for one (1) year following the date of purchase.
- Warranty does not cover standard wear items such as the nozzle, orifice, blasting material, window and gaskets.
- Warranty does not cover misuse of the blast cabinet. This includes the failure to follow instructions.
- Warranty does not cover blast unit if altered or otherwise changed from its original state form the factory.
- WARRANTY DOES NOT COVER DAMAGES IN TRANSIT:
- IN SUCH CASES, THE RECEIVER SHOULD CONTACT THE FREIGHT CARRIER WITHIN 15 DAYS OF DELIVERY TO FILE A CLAIM. IT IS NOT THE RESPONSIBILITY OF THE MANUFACTURER OR SUPPLIER TO FILE THE CLAIM. IF ANY PARTS SHOULD BE REQUIRED TO FIX A FREIGHT DAMAGED UNIT, THE RECEIVER WILL BE BILLED ACCORDINGLY. THIS BILL CAN THEN BE TURNED OVER OT THE FREIGHT CARRIER. USERS SHOULD CALL THEIR DISTRIBUTOR OR THE FACTORY UPON INSPECTION/DISCOVERY OF ANY PROBLEM. A TECHNICAL PERSON CAN ASSIST YOU.
- This warranty grants the user certain legal rights. Users and purchasers may also be protected by other rights that vary with location.
- NOTE: Except for the warranties set forth above, Cyclone makes no other warranties of any kind - express or implied. This includes warranties of merchantability or fitness of product for a particular purpose.

## TROUBLESHOOTING

PROBLEM	CAUSE	REMEDY
Excessive Dust	Dust collection system malfunctioning	Empty canister & replace or clean filter bag
	Abrasive Media worn out	Replace Media
Uneven Blasting Action	Too much media in hopper	Remove excess media
	Moisture present in air line	Install moisture separator
	Top of abrasive tube covered	Move media away from top of pickup tube
	Media worn out	Replace with new media
Inadequate speed or efficiency of blast	Worn blast gun parts	Inspect/adjust/replace parts
	Too much blast material	Remove excess material, 10-15 pounds max
	Regulate air to 70-90 PSI	Regulate air to 70-90 PSI
	Replace nozzle	Replace nozzle
Poor Blast Pattern	Dry environmental conditions	Install static electricity band
	Change in humidity	Get lined gloves Stand on cardboard/rubber mat
Static Electricity	Faulty ground wiring	Check electrical wiring
	Too much media in hopper	Remove excess material
Surging	Excessively worn blast gun parts	Properly replace parts
Unit Won't Blast		